

MATERIAL :- BRASS
ALLOY :-
TREATMENT :- DULL TIN PLATING
B CODE :- 78
B APPROVAL SIGN:- APD
ADDITIONAL REQUIREMENTS :- N/A
ROHS REQUIRED :- YES
DESIGN DATE:- 13.11.14

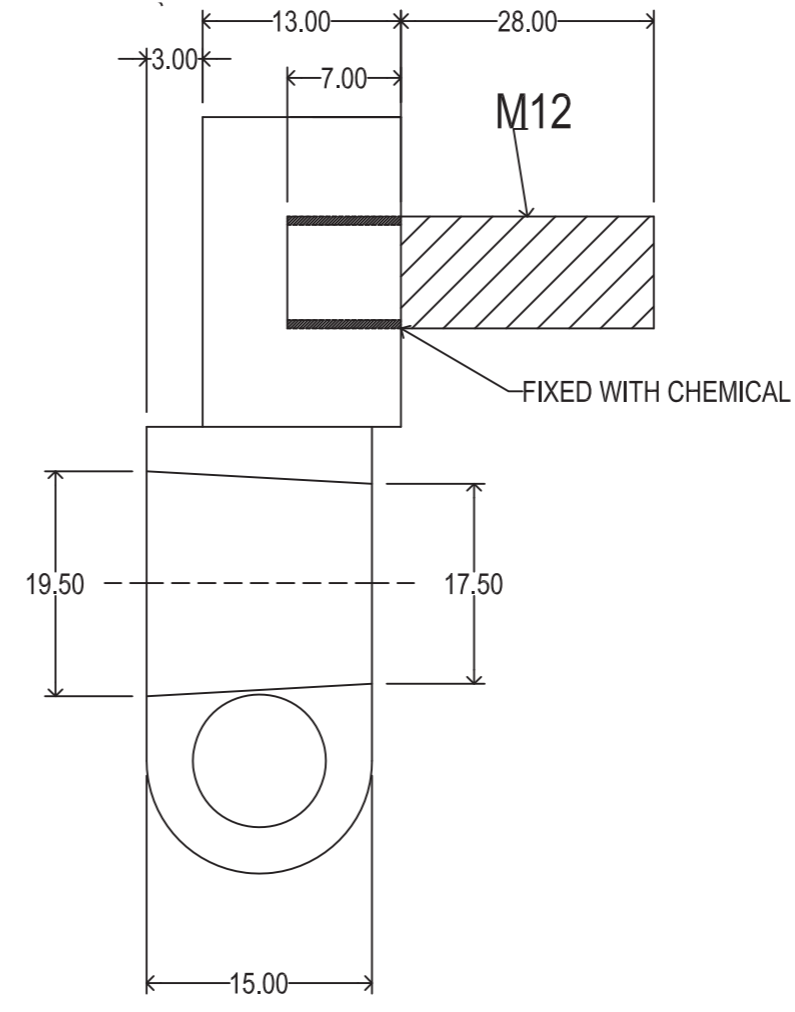
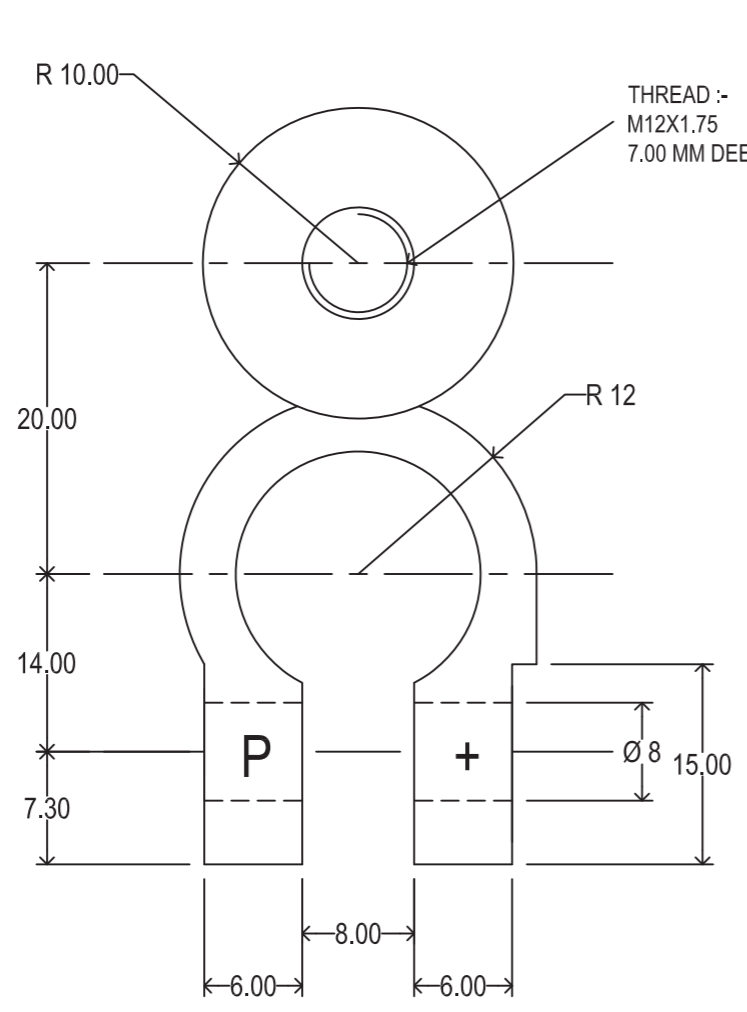

FASTNER DETAIL

- 1) 1PCS - M8X30 "D" SHAPE BOLT .
- 2) 1PCS - M8 NUT
- 3) 1PCS - M12X35 STUD (W/O HEAD)
- 4) 1PCS - M12 NUT
- 4) 1PCS - M12 DISK PLATE

PLATING DETAIL

- 1) FASTNER :- DULL TIN
- 2) TERMINAL :- DULL TIN

SIZE :- 22.00 ROUND
WEIGHT :- 115 g
DIE BOX NO. :- 23

<p>GENERAL NOTES & TOLERANCE AS PER ISO 2768 - 1 1989</p> <p>1. UNLESS OTHERWISE STATED, ALL DIMENSIONS ARE IN <u>INCHES</u>.</p> <p>2. REMOVE ALL BURRS AND SHARP EDGES.</p> <p>3. TOLERANCE FOR DIMENSIONS.</p> <p>4. CLASS OF DEVIATIONS :- <u>MEDIUM</u></p> <p>5. BELOW TOLERANCE ARE FOR TURN COMPONENTS. <u>DO NOT USE THIS TOLERANCE ON CAST PRODUCT, OR FORGED PRODUCT.</u></p> <p>6. FOR CRITICAL / IMPORTANT DIMENSION USE ELLIPSES SIGN.</p> <p>7. MULTIPLY INCHES X 25.4 = MILLIMETER (MM)</p>										<p>GENERAL NOTES & TOLERANCE AS PER ISO 2768 - 1 1989</p> <p>1. UNLESS OTHERWISE STATED, ALL DIMENSIONS ARE IN <u>MM</u>.</p> <p>2. REMOVE ALL BURRS AND SHARP EDGES.</p> <p>3. TOLERANCE FOR DIMENSIONS.</p> <p>4. CLASS OF DEVIATIONS :- <u>MEDIUM</u></p> <p>5. BELOW TOLERANCE ARE FOR TURN COMPONENTS. <u>DO NOT USE THIS TOLERANCE ON CAST PRODUCT, OR FORGED PRODUCT.</u></p> <p>6. FOR CRITICAL / IMPORTANT DIMENSION USE ELLIPSES SIGN.</p> <p>7. MULTIPLY MILLIMETERS (MM) X 0.03937 = INCHES</p> <p>8. DIVIDE MILLIMETERS BY 25.4 = INCHES</p>									
PERMISSIBLE DEVIATIONS IN MM FOR RANGES IN NOMINAL LENGTHS			PERMISSIBLE DEVIATIONS IN MM FOR RANGES IN NOMINAL LENGTHS			PERMISSIBLE DEVIATIONS IN DEGREES AND MINUTES FOR RANGES IN NOMINAL LENGTHS			PERMISSIBLE DEVIATIONS IN MM FOR RANGES IN NOMINAL LENGTHS			PERMISSIBLE DEVIATIONS IN MM FOR RANGES IN NOMINAL LENGTHS			PERMISSIBLE DEVIATIONS IN DEGREES AND MINUTES FOR RANGES IN NOMINAL LENGTHS				
EXTERNAL RADIUS CHAMFER HEIGHT			LINEAR AND DIAMETRAL DIMENSIONS			ANGULAR DIMENSIONS LENGTH OF SHORTER SIZE			EXTERNAL RADIUS CHAMFER HEIGHT			LINEAR AND DIAMETRAL DIMENSIONS			ANGULAR DIMENSIONS LENGTH OF SHORTER SIZE				
0.0196	0.1191	0.2362	0.0118	0.2785	1.2204	4.7637	0.00	0.4330	2.0076	0.50	3.00	6.00	0.30	7.00	31.00	121.00	0.00	11.00	51.00
0.1191	0.2362	0.3937	0.2362	1.1611	4.7244	12.401	0.3937	1.9685	4.7244	3.00	6.00	10.00	6.00	30.00	120.00	315.00	10.00	50.00	120.00
±0.0078	±0.0196	±0.0393	±0.0039	±0.0078	±0.0118	±0.0196	±1°	±1° 30'	±1° 30'	±0.20	±0.50	±1.00	±0.10	±0.20	±0.30	±0.50	±1°	±1° 30'	±1° 30'

Battery terminal with M12 thread positive D

Material: Units: mm

Scale: 1:1 Checked:

Drawn: hFd Date: 14/10/15

Article number: 68061300

Tolerances: linear ±0.2mm
Angular ±0.5°

A3

Drawing: 10000010592_00